

INSTALLATION INSTRUCTIONS

ISO-CONNECT EPDM SEALING COLLAR

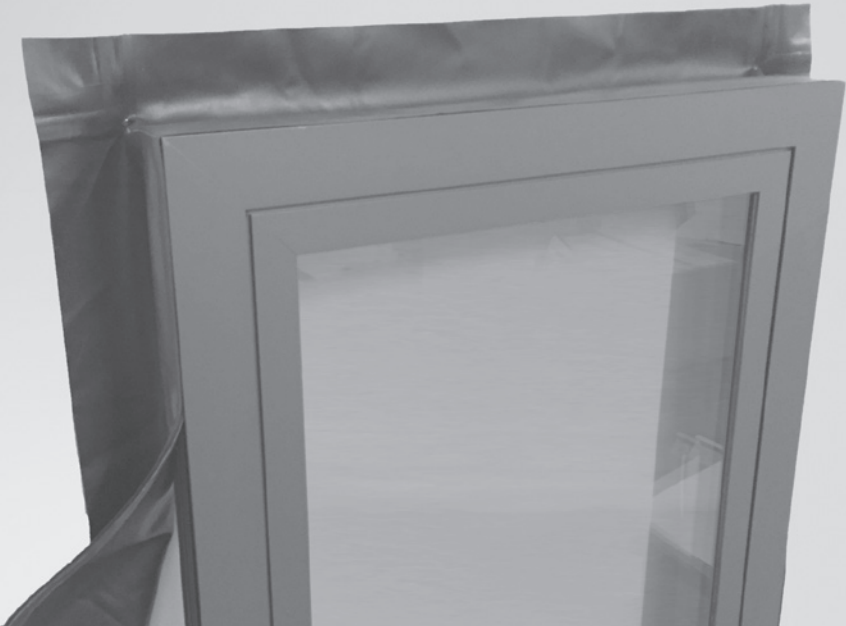

For external sealing of window and door elements that are installed in the facade with metal angles in front of the load-bearing wall.



- For permanently air tight joint sealing
- As protection against the weather
- To save energy

complies with the requirements of the Building Energy Act (EnEV was valid 31.10.20) and the recommendations of the RAL „installation guide“.

Scan here to view
construction site
video:



PREPARATION

SURFACE

1. The surfaces to be bonded must be free of moisture, dust, release agents, oil, grease and other anti-adhesive substances.
2. Pre-treat porous and absorbent surfaces with primer, if necessary. Note the application temperature specified on the product data sheet.

TOOLS

- Tape measure or folding ruler
- Scissors or knife
- Pressure roller
- Cartridge gun (ISO-TOP PRESSFIX) for adhesive

The ISO-CONNECT EPDM SEALING COLLAR is fitted after the window has been fully installed.

APPLICATION

1. Pull the sealing collar over the two top corners, adjust it to the right position, then stretch it down tight over the 2 bottom corners. Pull the sealing collar tight and flat over the window frame so there are no creases. The sealing surface must lie as flat as possible against the wall.

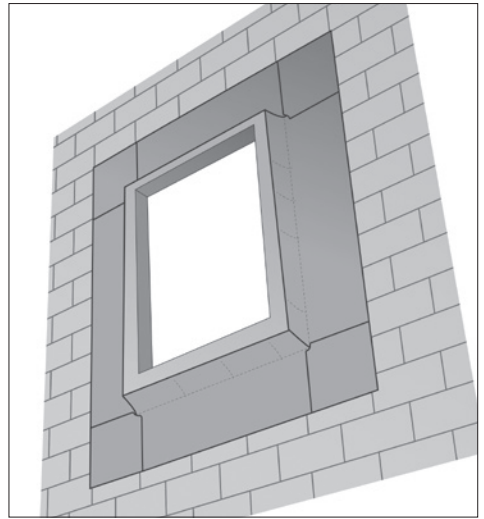
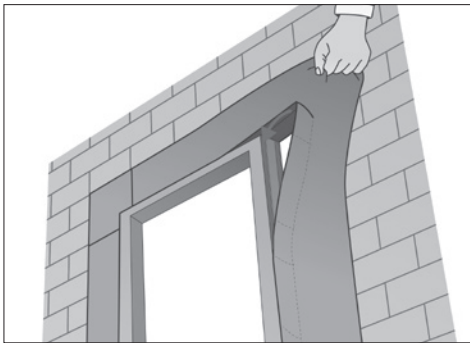

2. Now fold back the front section to the window frame so that the protective film of the butyl adhesive strip* can be peeled off piece by piece and the sealing collar stuck flush with the front edge of the window frame. Press in to place.

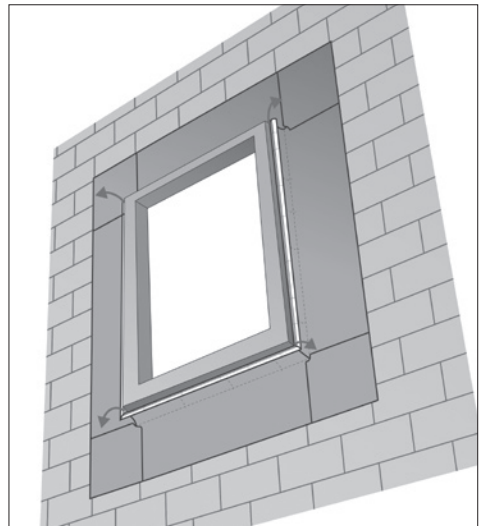

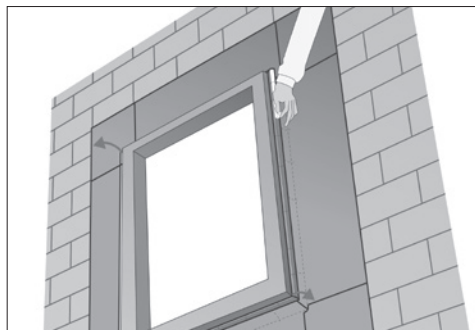

3. Use a pressure roller to press the butyl adhesive tape flat over the entire frame surface.

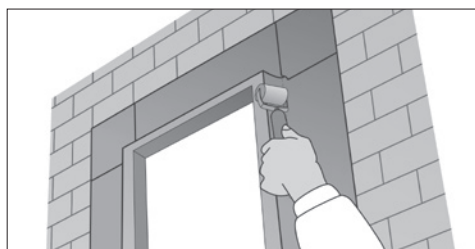

If a eurogroove gasket is used, the sealing collar is installed in the same way.

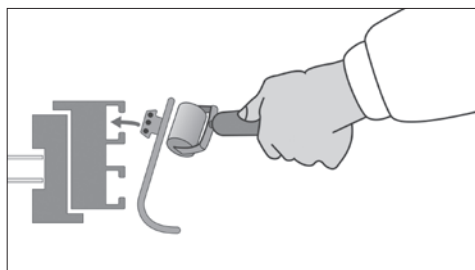

We recommend that you also seal the corners between the sealing collar and frame** with ISO-TOP FLEX-ADHESIVE XP.

To install on the wall surface, use two continuous beads of ISO-TOP FLEX-ADHESIVE XP. One of these beads must be applied at the edge of the foil where it meets the masonry. Ideally it should cover the edge slightly to prevent any water backflow.

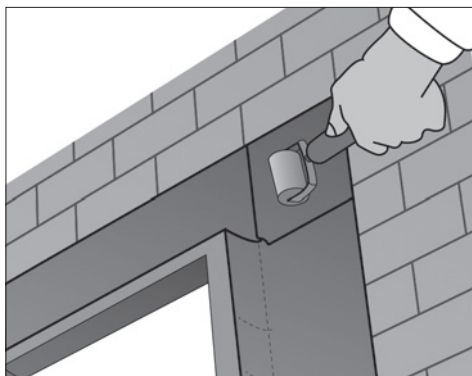

TIP

Small irregularities in the surface to be bonded can be compensated by applying sufficient adhesive.

Use a pressure roller to roll the adhesive beads flat and even to ensure a good bonding to the substrate. Any cavities should be sealed as well.

The metal brackets used to fasten the components must be completely covered with the sealing collar. We recommend to cover them by ≥ 50 mm to prevent leakage.

OPTIONAL SEALING WITH PRESHAPED ISO-CONNECT EPDM SEALING CORNERS AND ISO-CONNECT EPDM SEALING STRIPS

As an alternative to sealing with the ISO-CONNECT EPDM sealing collar, the window and door elements installed in front of the wall can be sealed all round with preshaped EPDM sealing corners and EPDM sealing strips. The steps to prepare the surface for this installation and the tools to be used are as described for the ISO-CONNECT EPDM SEALING COLLAR.

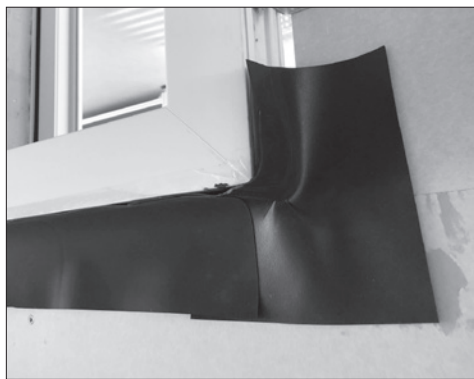

The first step is to apply two beads of adhesive to stick the preshaped EPDM sealing corners to the two bottom element corners on the wall and to the window frame. This can be done

using the ISO-TOP FLEX-ADHESIVE XP or using butyl self-adhesive strips (optional) applied to the sealing corners.

Then stick the bottom and side sealing strips to the wall surface and window frame, running them horizontally and vertically.

Follow this with the two top EPDM sealing corners and finally run the top EPDM sealing strip horizontally between the EPDM sealing corners. The overlap where the sealing strips are joined should be ≥ 100 mm. Glue connecting joints between the sealing corners and sealing strips using ISO-TOP FLEX-ADHESIVE XP. Roll all glued surfaces with a hard pressure roller to ensure that the adhesive is adequately distributed and to achieve a good bond with the adhering surfaces.

Ideally work from bottom to top to allow any water to run out (as when tiling a roof) and to prevent the water seeping back at the edges of the sealing strip.

Seal all connections between the individual sealing components using ISO-TOP FLEX-ADHESIVE XP.

Apply the top adhesive bead running horizontally so that it lies directly on the edge of the sealing strip and covers it slightly. This will prevent any water running down the facade seeping back in to the seal.

* Optional: can be ordered with and without butyl adhesive strips

** If the eurogroove gasket system is used